

Stehplätze / standees

Lastfall M3: 36,06 m<sup>2</sup> x 4 Personen / m<sup>2</sup> = 144 Personen  
 Load Case M3: 36,06 m<sup>2</sup> x 4 People / m<sup>2</sup> = 144 People  
 Lastfall M4: 36,06 m<sup>2</sup> x 6 Personen / m<sup>2</sup> = 216 Personen  
 Load Case M4: 36,06 m<sup>2</sup> x 6 People / m<sup>2</sup> = 216 People

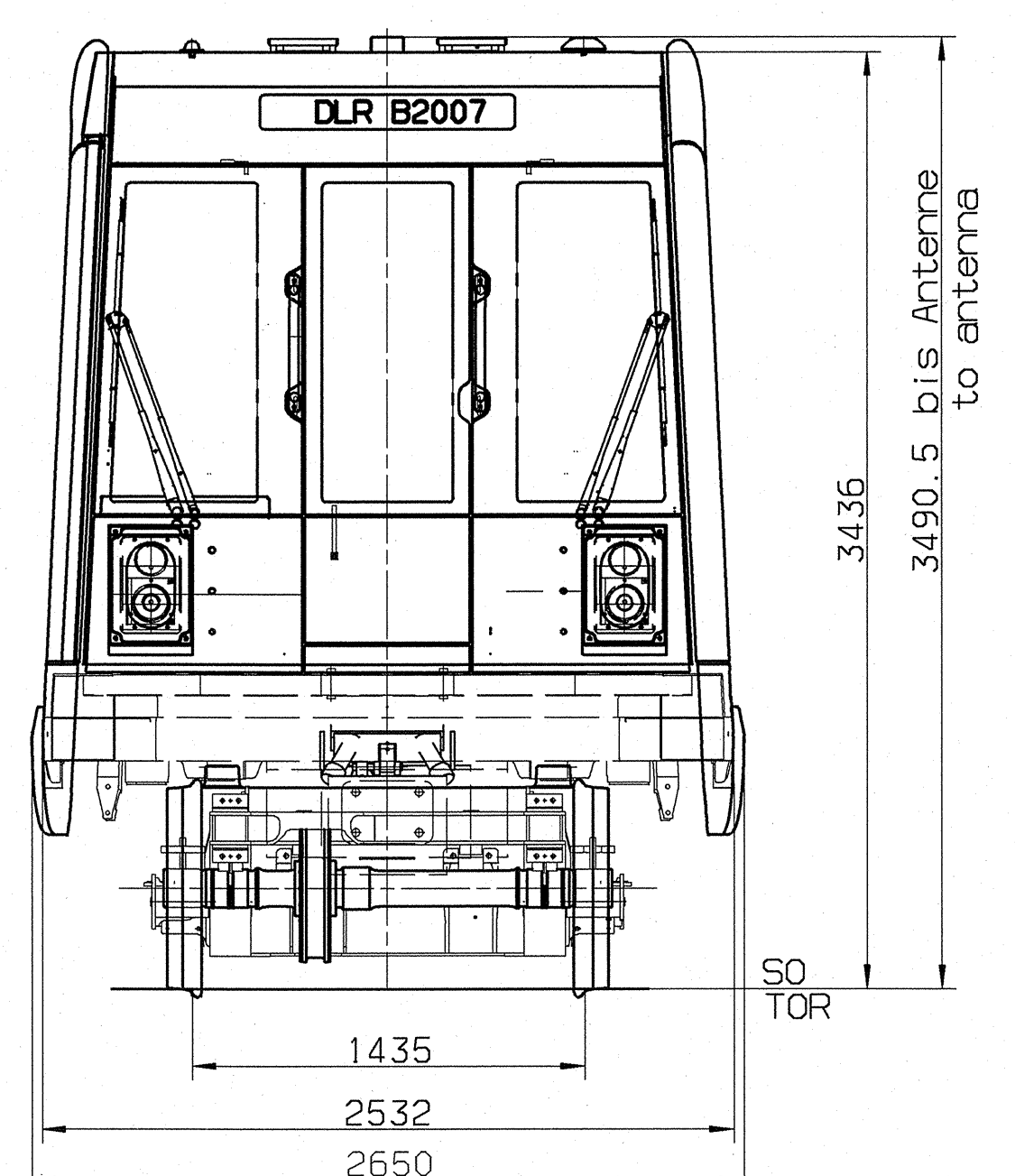
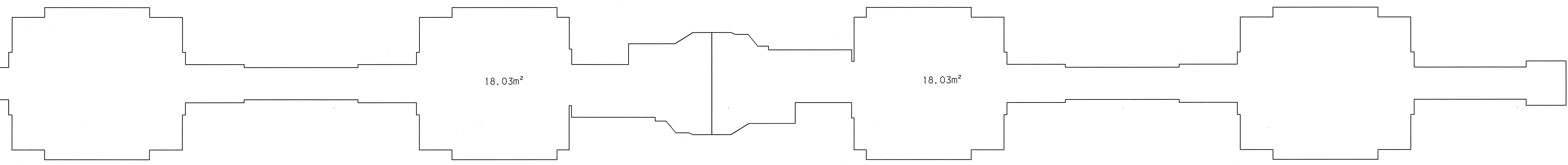

SEATING CAPACITY	
FORWARD FACING	32
SIDWAYS FACING	20
TIP-UP	4
<b>TOTAL</b>	<b>56</b>

150 2788-00		0.0		131 - Baukasten	
A	30467	12-07-06	By	EN 150 1990-01	
B	31576	20-05-06	Br	EN 150 1992	
C	31577	04-10-06	Br		
D	41219	07-07-06	Br		
Index		Revisi	Cost	Verf	Verf
Date		Drawn	05-05-27	Checked	01-03-28
Name		Approved		Date	Name
Status		Rev	01	Date	Name
BOMBARDIER		1.728:01.00.00/0		Projektbild Vehicle layout	
				01 / 01	