

NOTES

1. THE CONTRACTOR SHALL BE RESPONSIBLE FOR ESTABLISHING THE POSITION AND STATUS OF ALL STATUTORY UTILITY APPARATUS PRIOR TO COMMENCING ANY WORKS. THE CONTRACTOR SHALL COORDINATE AND UNDERTAKE ALL WORKS IN CONJUNCTION AND AGREEMENT WITH THE AFFECTED STATUTORY UTILITY COMPANIES AS NECESSARY.
2. ALL ITEMS SHOWN IN GREY ARE EXISTING AND ARE TO REMAIN UNLESS STATED OTHERWISE.
3. DO NOT SCALE FROM THIS DRAWING. USE FIGURED DIMENSIONS ONLY. ALL DIMENSIONS AND LEVELS ARE IN METRES, UNLESS OTHERWISE STATED.
4. FOR STANDARD DETAILS REFER TO STANDARD DETAIL DRAWINGS 60320925-CP12-SD-0401 TO 1202.
5. DESIGN BASED ON TOPOGRAPHICAL SURVEY BY DAVID J. WEBB SURVEYS LTD. (JOB NO 3553). LEVELS AND SETTING OUT TO BE CHECKED ON SITE BY CONTRACTOR PRIOR TO THE START OF WORKS.
6. THIS DRAWING SHALL BE READ IN CONJUNCTION WITH ALL OTHER DETAILED DESIGN DRAWINGS, STANDARD DETAILS AND SPECIFICATIONS FOR WORKS FOR THIS SCHEME.
7. ALL DETAILS TO BE CHECKED ON SITE BY THE SUPERVISING ENGINEER.
8. ALL COVERS WITHIN TACTILE PAVING NEED TO BE RECESSED AND FILLED WITH TACTILE SLABS.

KEY

- Provide and lay removable traffic island. In accordance with 60320925-F001-SD-0001-0002.
- Provide and lay 600x900x65mm York Stone modular paving slabs. Refer to drawing 60320925-CP12-SD-1102 for standard details. Existing areas of York Stone paving to be adjusted to suit new levels.
- Provide and lay 100x100x65mm granite setts. Refer to drawing 60320925-CP12-SD-1102 for standard details.
- Provide and lay 400x400x65mm ASP contrasting grey coloured tactile paving. Refer to drawing 60320925-CP12-SD-1103 for standard details.
- Provide and lay 150/300mm Granite kerb Refer to drawing 60320925-CP12-SD-1101 to 1104 for standard details.
- Provide and lay 150/300mm dropped Granite kerb. Refer to drawing 60320925-CP12-SD-1101 to 1104 for standard details.
- Kerb type. Refer to drawing 60320925-CP12-SD-1101 to 1104 for standard details.
- Provide and lay 300mm radius granite quadrant on the traffic islands.
- Provide and lay 450mm radius granite quadrant on the traffic islands.
- Provide and install pedestrian guard railing. Refer to drawing 60320925-CP12-SD-0401 Type 1A for standard details.
- Site boundary/extends.
- TLRN Boundary.
- Reinstall cast iron bollard.
- Reinstall City of London bollard.
- Reinstall City of London pillar.

3	For Construction	AC	SJR	08.01.18
2	For Final Comment	AC	SJR	04.01.18
1	For Comment	AC	DJH	24.10.17
Rev	Revision details	Chkd	Appd	Date

Drawn: HVN	Preliminary
Design: DM	For comment
Chkd: AC	For tender
Appd: DJH	For construction
Date: 24.10.17	As constructed



Project Name
Cycle Superhighway Trinity Square - NH2017_TO_0093D

Drawing Title
Transportation
1100 - Kerb and Footway
(Sheet 1 of 2)

Original Drawing Size : A1	Dimensions :
Scale : 1:200 @ A1	Copyright © ConwayAecom

Drawing No 60320925-F100-DWG-1101	Rev 3
--------------------------------------	----------

Based upon a reproduction from the Ordnance Survey mapping with the permission of the Controller of Her Majesty's Stationary Office © Crown Copyright. Unauthorised reproduction infringes Crown Copyright and may lead to prosecution or civil proceedings. Transport for London, Account/Licence No. 100035971/083, 2014.

This drawing has been prepared for the use of CONWAY AECOM's client. It may not be used, modified, reproduced or relied upon by third parties, except as agreed by CONWAY AECOM or as required by law. CONWAY AECOM accepts no responsibility, and denies any liability whatsoever, to any party that uses or relies on this drawing without CONWAY AECOM's express written consent. Do not scale this document.

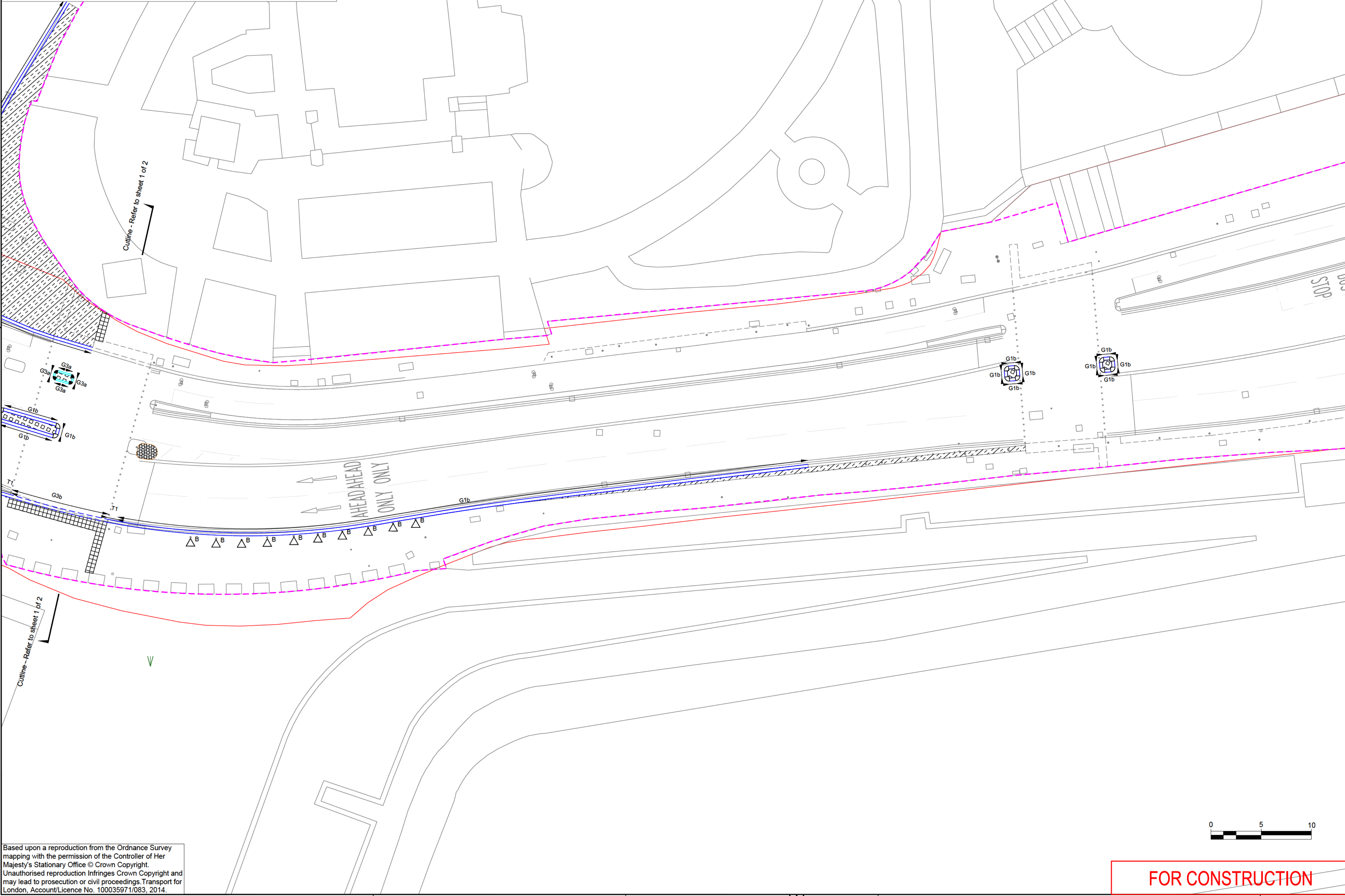
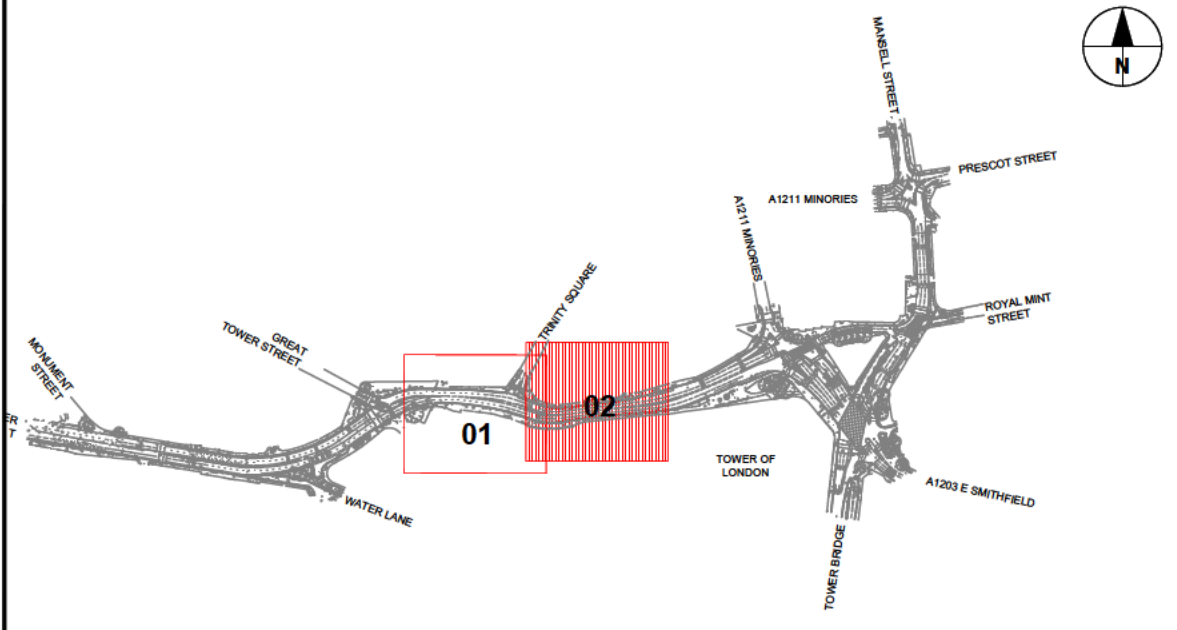

Based upon a reproduction from the Ordnance Survey mapping with the permission of the Controller of Her Majesty's Stationary Office © Crown Copyright. Unauthorised reproduction infringes Crown Copyright and may lead to prosecution or civil proceedings. Transport for London, Account/Licence No. 100035971/083, 2014.

- ### NOTES
1. THE CONTRACTOR SHALL BE RESPONSIBLE FOR ESTABLISHING THE POSITION AND STATUS OF ALL STATUTORY UTILITY APPARATUS PRIOR TO COMMENCING ANY WORKS. THE CONTRACTOR SHALL COORDINATE AND UNDERTAKE ALL WORKS IN CONJUNCTION AND AGREEMENT WITH THE AFFECTED STATUTORY UTILITY COMPANIES AS NECESSARY.
 2. ALL ITEMS SHOWN IN GREY ARE EXISTING AND ARE TO REMAIN UNLESS STATED OTHERWISE.
 3. DO NOT SCALE FROM THIS DRAWING. USE FIGURED DIMENSIONS ONLY. ALL DIMENSIONS AND LEVELS ARE IN METRES, UNLESS OTHERWISE STATED.
 4. FOR STANDARD DETAILS REFER TO STANDARD DETAIL DRAWINGS 60320925-CP12-SD-0401 TO 1202.
 5. DESIGN BASED ON TOPOGRAPHICAL SURVEY BY DAVID J. WEBB SURVEYS LTD. (JOB NO 3553). LEVELS AND SETTING OUT TO BE CHECKED ON SITE BY CONTRACTOR PRIOR TO THE START OF WORKS.
 6. THIS DRAWING SHALL BE READ IN CONJUNCTION WITH ALL OTHER DETAILED DESIGN DRAWINGS, STANDARD DETAILS AND SPECIFICATIONS FOR WORKS FOR THIS SCHEME.
 7. ALL DETAILS TO BE CHECKED ON SITE BY THE SUPERVISING ENGINEER.
 8. ALL COVERS WITHIN TACTILE PAVING NEED TO BE RECESSED AND FILLED WITH TACTILE SLABS.

- ### KEY
- Provide and lay removable traffic island. In accordance with 60320925-F001-SD-0001-0002.
 - Provide and lay 600x900x65mm York Stone modular paving slabs. Refer to drawing 60320925-CP12-SD-1102 for standard details. Existing areas of York Stone paving to be adjusted to suit new levels.
 - Provide and lay 100x100x65mm granite setts. Refer to drawing 60320925-CP12-SD-1102 for standard details.
 - Provide and lay 400x400x65mm ASP contrasting grey coloured tactile paving. Refer to drawing 60320925-CP12-SD-1103 for standard details.
 - Provide and lay 150/300mm Granite kerb Refer to drawing 60320925-CP12-SD-1101 to 1104 for standard details.
 - Provide and lay 150/300mm dropped Granite kerb. Refer to drawing 60320925-CP12-SD-1101 to 1104 for standard details.
 - Kerb type. Refer to drawing 60320925-CP12-SD-1101 to 1104 for standard details.
 - Provide and lay 300mm radius granite quadrant on the traffic islands.
 - Provide and lay 450mm radius granite quadrant on the traffic islands.
 - Provide and install pedestrian guard railing. Refer to drawing 60320925-CP12-SD-0401 Type 1A for standard details.
 - Site boundary/extends.
 - TLRN Boundary.
 - Reinstall cast iron bollard.
 - Reinstall City of London bollard.
 - Reinstall City of London pillar.

3	For Construction	AC	SJR	08.01.18
2	For Final Comment	AC	SJR	04.01.18
1	For Comment	AC	DJH	24.10.17
Rev	Revision details	Chkd	Appd	Date

Drawn: HVN	Preliminary
Design: DM	For comment
Chkd: AC	For tender
Appd: DJH	For construction
Date: 24.10.17	As constructed



Project Name
Cycle Superhighway Trinity Square - NH2017_TO_0093D

Drawing Title
Transportation
1100 - Kerb and Footway
(Sheet 2 of 2)

Original Drawing Size : A1	Dimensions :
Scale : 1:200 @ A1	Copyright © ConwayAecom
Drawing No 60320925-F001-DWG-1102	Rev 3

This drawing has been prepared for the use of CONWAY AECOM's client. It may not be used, modified, reproduced or relied upon by third parties, except as agreed by CONWAY AECOM or as required by law. CONWAY AECOM accepts no responsibility, and denies any liability whatsoever, to any party that uses or relies on this drawing without CONWAY AECOM's express written consent. Do not scale this document.