

DUCTING, LOOP & DETECTION POINT PLAN  
SCALE 1:500

BUS STOP REFERENCE ON DRAWING	LOCATION	FLAG TO STOPLINE (METERS)	SHELTER TO STOPLINE (METERS)	LENGTH OF SHELTER (METERS)
BS1	BALHAM HIGH ROAD NW/B	36.0	37.5	4.0
BS2	TOOTING BEC ROAD SW/B	46	-	-
BS3	UPPER TOOTING ROAD NE/B	37.7	29.7	5.8
BS4	TRINITY ROAD SE/B	16.7	-	-

DETECTOR NAME	BUS JUNCTION ID	DETECTOR REFERENCE POINT	DISTANCE FROM STOP LINE	STOP CONDITION	LENGTH OF SHELTER	MAX DISTANCE OFFSET	MOVEMENT	FROM STREET	TO STREET	DIRECTION
ISB0	-	AT FLAG OF BS1 ON BALHAM HIGH ROAD	36.0	2	20	10	1	BALHAM HIGH ROAD	SW/B	UPPER TOOTING ROAD
ISB1	-	AT FLAG OF BS2 ON TOOTING BEC ROAD	46.0	2	20	10	2	TOOTING BEC ROAD	NW/B	TRINITY ROAD
ISB2	-	AT FLAG OF BS3 ON UPPER TOOTING ROAD	37.7	2	20	10	3	UPPER TOOTING ROAD	NE/B	BALHAM HIGH ROAD
ISB3	-	AT FLAG OF BS4 ON UPPER TRINITY ROAD	16.7	2	10	10	4	TRINITY ROAD	SE/B	TOOTING BEC ROAD

LOOP NUMBER	LOOP DIMENSION & POSITION (METERS)	DISTANCE TO STOPLINE (METERS)	BUS DETECTOR CONNECTION	REFERENCE POINT	DISTANCE TO LOOP LEADING EDGE	PROPOSED OR EXISTING
S00	A: 0.9, B: 3.0, C: 14.0	182.0	-	0.2m from kerb	0.0	EXISTING
S01	A: 2.0, B: 2.4, C: 11.2	182.0	-	0.2m from kerb	0.0	EXISTING
S02	A: 0.7, B: 3.0, C: 10.3	182.0	-	0.2m from kerb	15.0	EXISTING
S03	A: 2.0, B: 1.2, C: 9.0	202.0	-	0.2m from kerb	3.5	EXISTING
S04	A: 1.8, B: 3.0, C: 11.3	215.0	-	0.2m from kerb	15.0	EXISTING

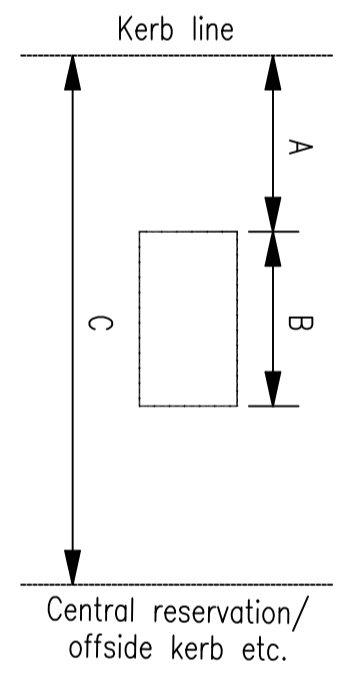

NOTE: SEE SLD/10/000148 FOR LOOP SD3

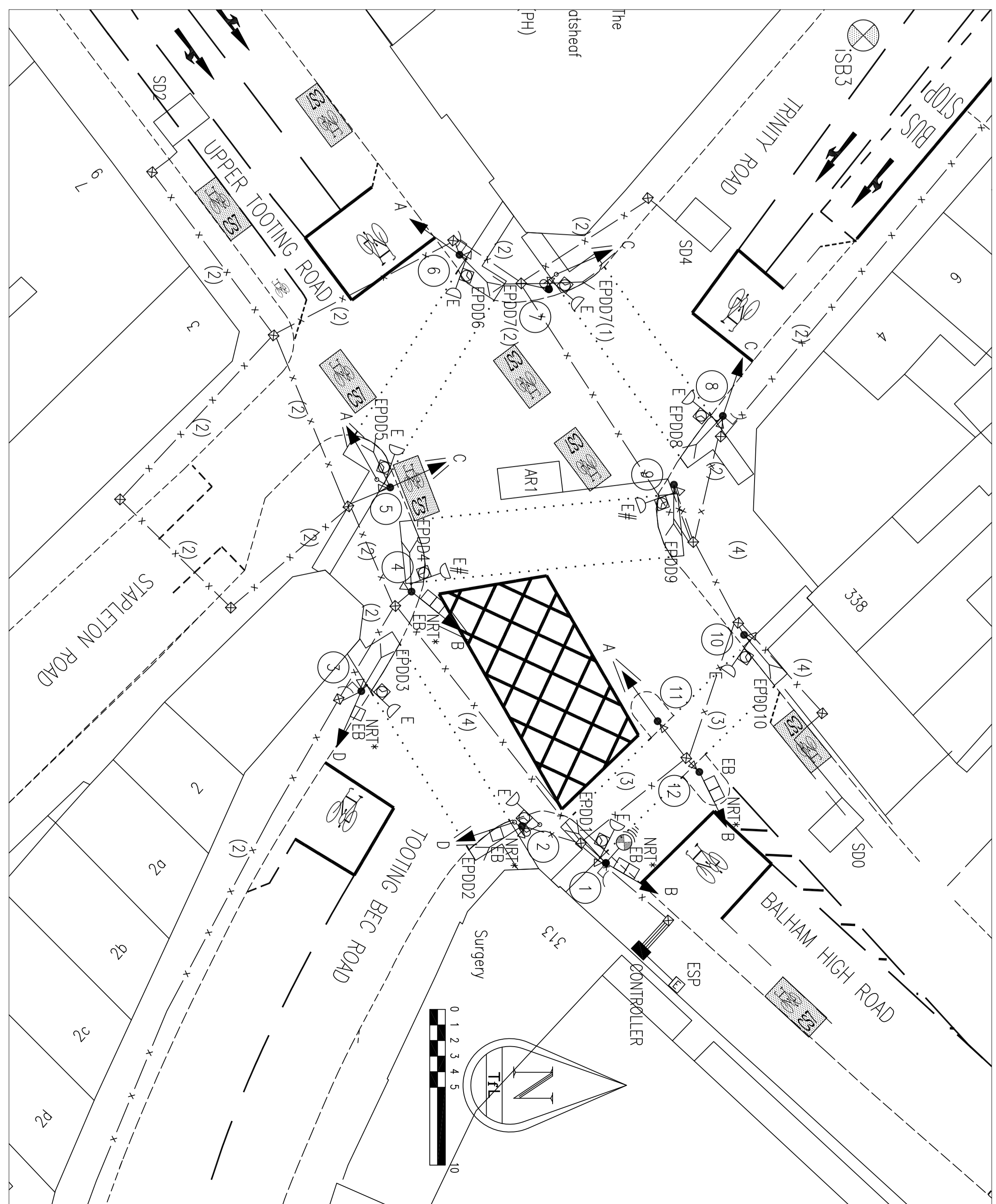

SCHEME PLAN  
SCALE 1:200

CONTROLLER
1
2
3
4
5
6
7
8
9
10
11
12
13
14
15
16
17
18
19
20
21
22

- NOTES
- SYMBOLS ARE IN ACCORDANCE WITH DRG No 95/GEN/9/15/56
  - EXISTING DUCT CONDITION UNKNOWN
  - 50mm DUCT FROM CONTROLLER TO ESP
  - 50mm DUCT UNDER KERB TO LOOP FEEDERS
  - RESERVES INSTALLED AT POLES 4, 6 & 8
  - ALL POLES
  - POLE ROTATING CONES FITTED TO RESERVATIONS ON ALL POLES
  - ADDRESSES FITTED TO RESERVATIONS ON ALL POLES
  - ALL POLES ARE AM POLES EXCEPT POLES 2 & 7
  - POLES 2 & 7 ARE 4m LINE BOX SIGNS
  - POLES 1, 2, 3, 4 & 12 CARRY NO RIGHT TURN & SECRET SIGNS (H&B)
  - POLES ARE BLACK IN COLOUR
  - 4m-12m LINE BOX SIGNS FITTED ON POLES 2 & 3
  - 5m-12m LINE BOX SIGNS FITTED ON POLES 1, 4 & 12
  - POLES 1, 2, 3, 4 & 12 CARRY NO RIGHT TURN & SECRET SIGNS (H&B)
  - HAZARD AROUND BASE OF POLE 8
  - BUS GEOMETRIC LOCATION
  - BUS AERIAL MOUNTED ON POLE 1
  - BLIND SPOT SAFETY MIRRORS MOUNTED ON POLES 1, 3, 6 & 8
  - BLIND SPOT SAFETY MIRRORS MOUNTED ON POLES 1, 2, 3, 4, 5, 6, 7, 8, 9 & 10
  - DOWNDOWN SIGNS FITTED ON POLES 1, 2, 3, 4, 5, 6, 7, 8, 9 & 10
  - SEE SLD/10/000148 FOR LOOP SD3

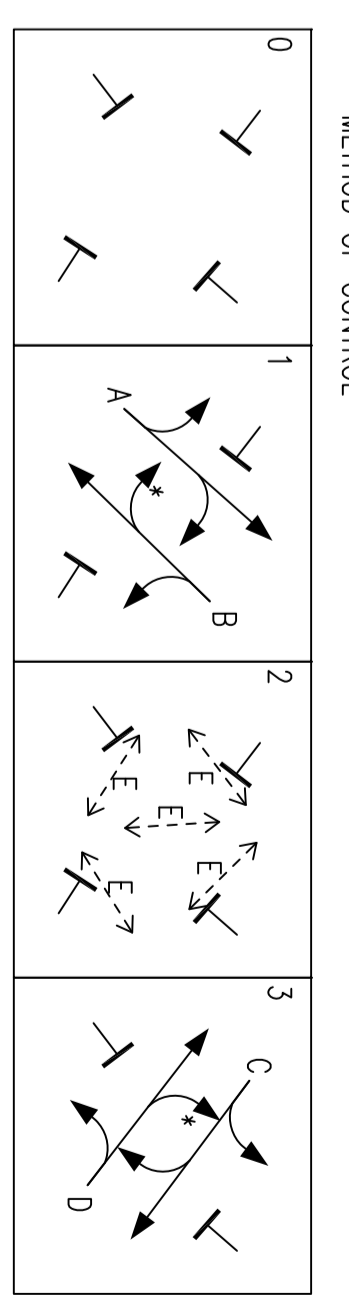

SECRET SIGNS

**WARNING**  
HAZARD AROUND  
BASE OF POLE 8

REV	DATE	DETAILS	CONTRACT
1	10/7/99	AS NOTIFIED - SIGNAGE TESTS	-
2	DEC 97	RE-DRAWN & SCOOT INCLUDED	ABERSON
3	17/7/01	JUNCTION WORKS	(S&S A&H)
4	APR 03	S30 SIGNALS MOUNTED	TL - SPC
5	SEP 06	S30 SIGNALS MOUNTED	TL - SPC
6	09/10/09	SITE WORKS COMPLETED	TL - S&S
7	15/07/10	TRAFIC MOUNTED	TL - S&S
8	16/03/11	NEW SIGNALS MOUNTED & BARRIERS OVER	TL - S&S
9	10/06/12	NEW SIGNALS MOUNTED & BARRIERS OVER	TL - S&S
10	15/06/12	S&S UNBARRIERS & MOUNTED ON	TR/S&S-MM
11	07/05/14	INSTALLATION NOT YET COMPLETED AS	TR/S&S-MM



scheme L B OF WANDSWORTH  
A24 BALHAM HIGH ROAD  
UPPER TOOTING ROAD  
A214 TOOTING BEC ROAD  
TRAFFIC SIGNALS LAYOUT  
date FEB 2001  
No. SLD/10/000006/11  
SCALE AS SHOWN

ALL RIGHTS RESERVED. This document is the property of London Underground Limited. It is not to be reproduced, stored in a retrieval system, or transmitted in any form or by any means, electronic, mechanical, photocopying, recording, or by any information storage and retrieval system, without the prior written permission of London Underground Limited. © London Underground Limited 2011. Licence No. 10000001