

Stehplätze / standees

Lastfall M3: 36,06 m² x 4 Personen / m² = 144 Personen
 Load Case M3: 36,06 m² x 4 People / m² = 144 People
 Lastfall M4: 36,06 m² x 6 Personen / m² = 216 Personen
 Load Case M4: 36,06 m² x 6 People / m² = 216 People

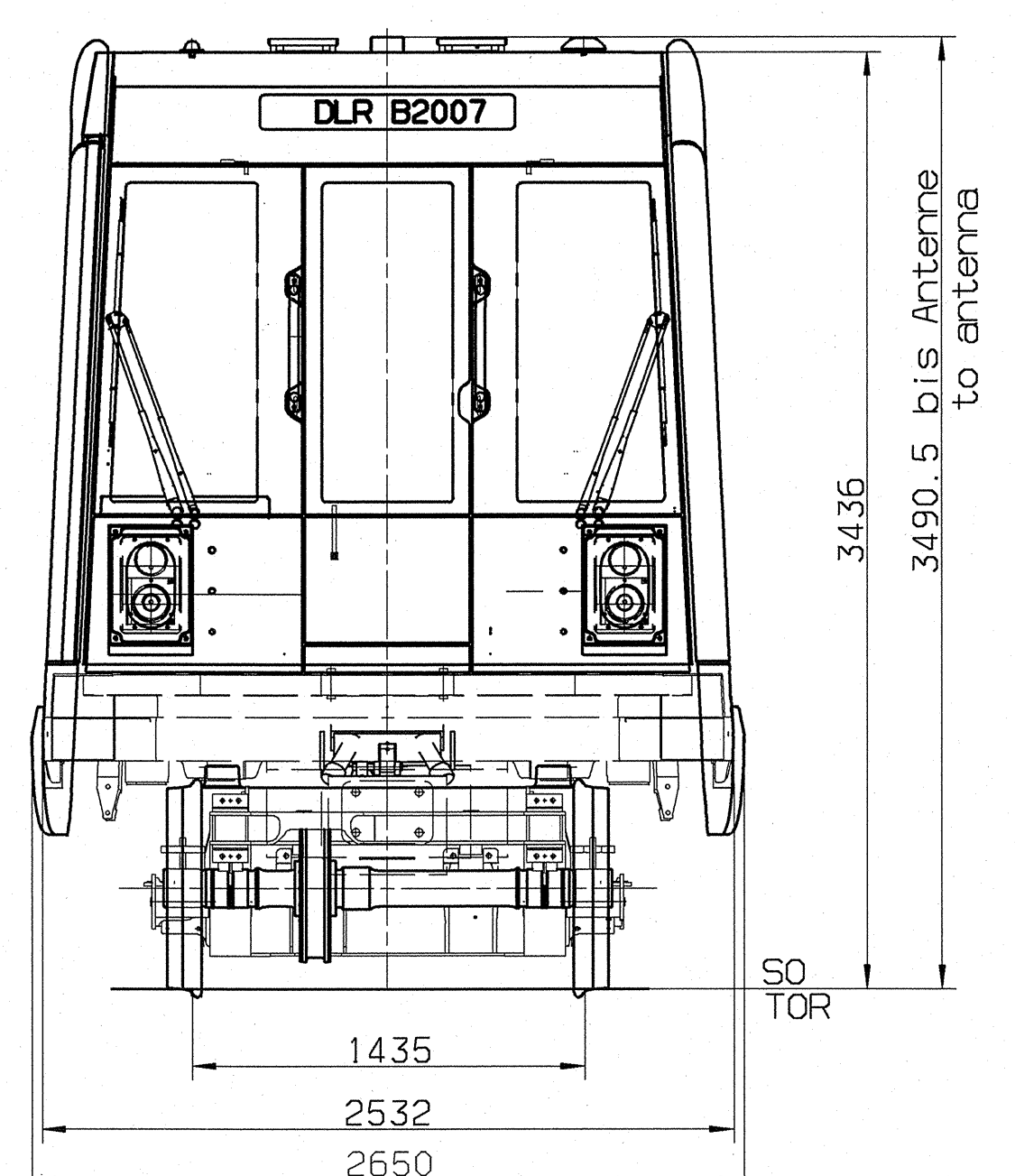
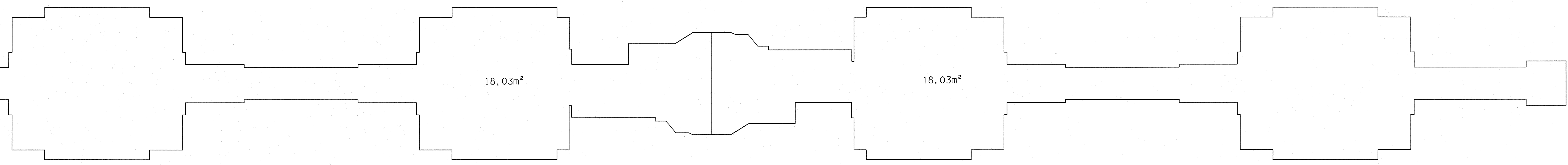

SEATING CAPACITY	
FORWARD FACING	32
SIDWAYS FACING	20
TIP-UP	4
TOTAL	56

Index	Revisi	Cont. no.	Date	Name	Proj. no.	Proj. name
A	30467	12-07-06	BJ	...	131	Baukasten
B	31576	20-05-06	BR	...	130	1302
C	31577	04-10-06	BR	...		
D	41219	07-07-06	BR	...		

BOMBARDIER

1.728:01.00.0:00/0

Projektbild
Vehicle layout

01 / 01