

LAYOUT 5

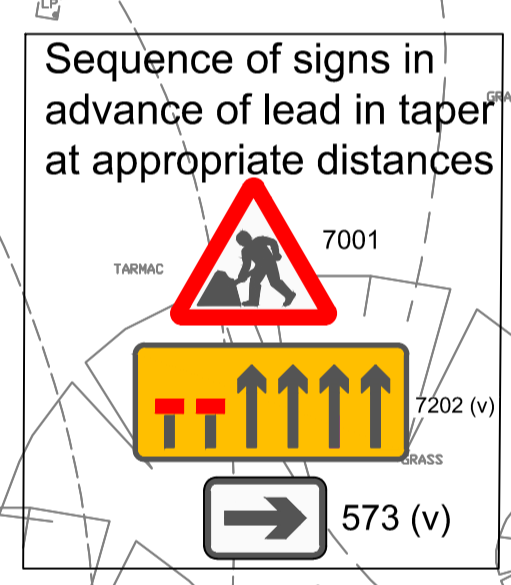
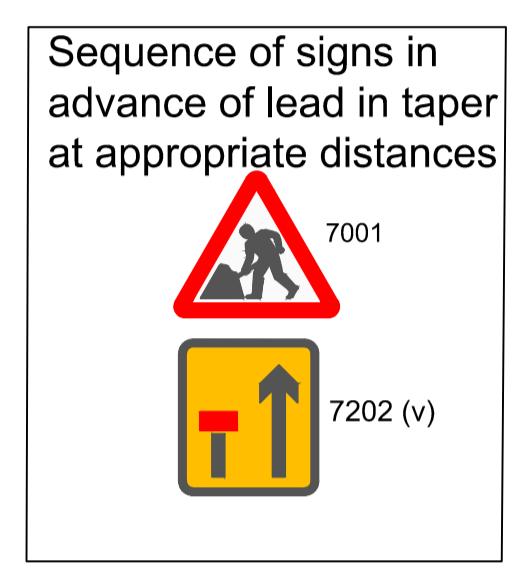
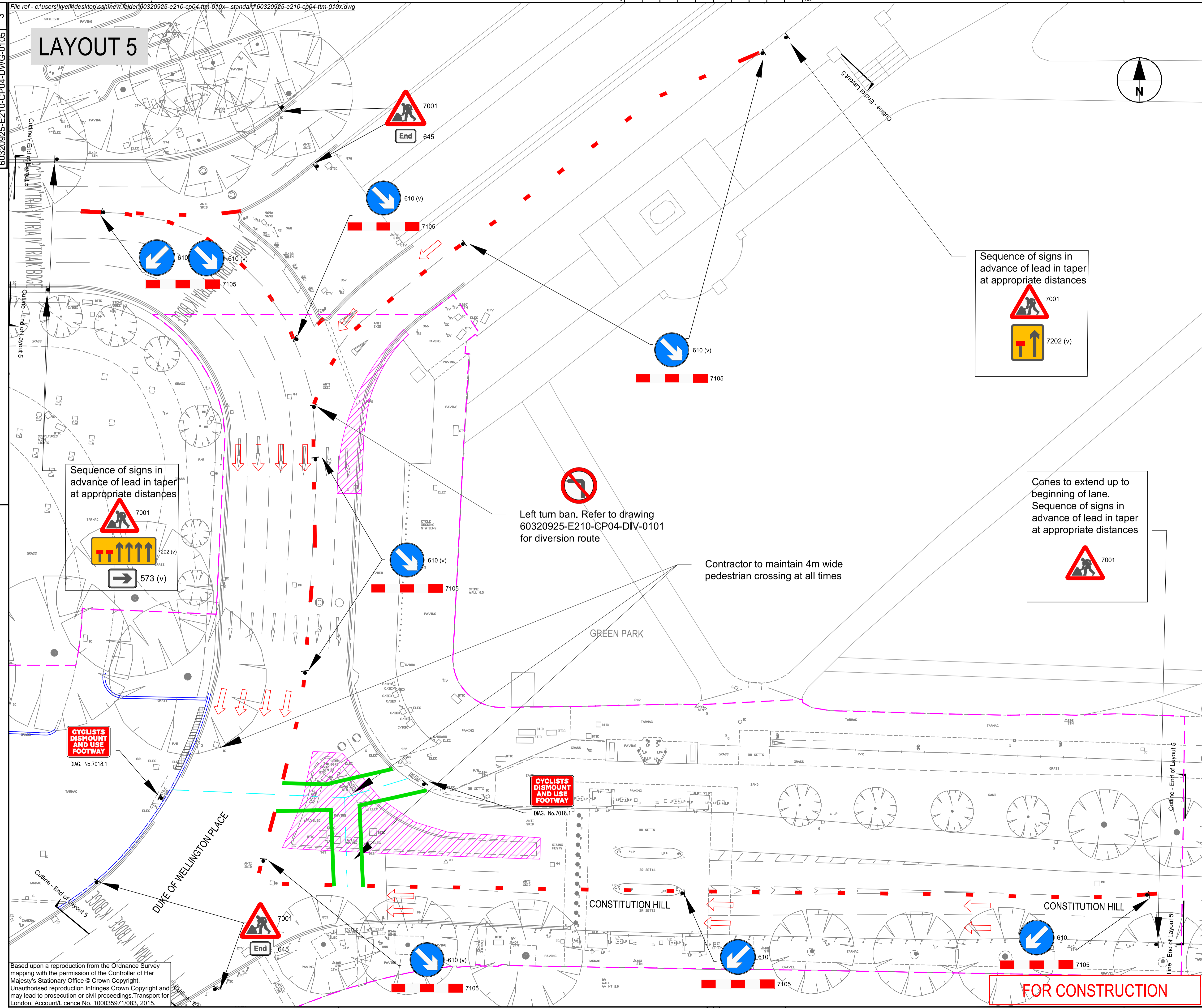

Left turn ban. Refer to drawing 60320925-E210-CP04-DIV-0101 for diversion route

Contractor to maintain 4m wide pedestrian crossing at all times

NOTES

- ALL DIMENSIONS ARE IN METRES UNLESS OTHERWISE STATED.
- ALL EXISTING ROAD MARKINGS SHOWN ARE INDICATIVE ONLY.
- ALL TEMPORARY TRAFFIC MANAGEMENT SHALL BE IN ACCORDANCE WITH CHAPTER 8 OF THE TRAFFIC SIGNS MANUAL 2009, TRAFFIC SIGNS REGULATIONS AND GENERAL DIRECTIONS 2002 AND SAFETY AT STREET WORKS AND ROAD WORKS, A CODE OF PRACTICE 2002 (2013 - EFFECTIVE 01/10/14).
- ALL TEMPORARY TRAFFIC MANAGEMENT SIGNS SHOULD BE LOCATED 450MM MINIMUM FROM THE KERB FACE.
- ALL TEMPORARY TRAFFIC MANAGEMENT SIGN LOCATIONS ARE INDICATIVE AND ARE SUBJECT TO ON SITE APPROVAL FROM THE SUPERVISOR.
- ALL THIRD PARTY ACCESS AND EGRESS FACILITIES ARE TO BE MAINTAINED AT ALL TIMES.
- WHERE PEDESTRIAN CROSSINGS ARE CLOSED, ALTERNATIVE PEDESTRIAN ROUTES ARE TO BE PROVIDED.
- INFORMATION BOARDS MUST BE DISPLAYED FOR ALL PEDESTRIAN DIVERSIONS.
- ALL TEMPORARY TRAFFIC MANAGEMENT TO INCLUDE A MINIMUM 0.5M WIDE SAFETY ZONE.
- CONE & ROAD DANGER SPACING TO BE AS PER CHAPTER 8, TRAFFIC SIGNS MANUAL 2009, TABLE A1.3 FOR A 30 MPH ALL PURPOSE DUAL/ SINGLE CARRIAGEWAY.
- FOR DIVERSION ROUTE REFER TO DRAWING NO. 60320925-E210-CP04-DIV-0101.
- ALL TEMPORARY TRAFFIC MANAGEMENT HAS BEEN DESIGNED TO ACCOMMODATE THE TURNING MOVEMENTS OF 15 METRE LUXURY COACHES AS PER THE CYCLE SUPERHIGHWAY DESIGN DIRECTIVE FROM TIL.
- ALL TEMPORARY TRAFFIC MANAGEMENT LANE WIDTHS HAVE BEEN DESIGNED TO INCORPORATE THE 'CYCLISTS AT ROADWORKS' DESIGN GUIDANCE AS PER THE CYCLE SUPERHIGHWAY DESIGN DIRECTIVE FROM TIL.

KEY

- Works area in accordance with TSM Chapter 8 and 'Safety at Street Works and Road Works'.
- Traffic cones in accordance with TSM Chapter 8 and 'Safety at Street Works and Road Works'.
- Traffic sign. Sign size in accordance with TSM Chapter 8 and 'Safety at Street Works and Road Works'.
- Pedestrian barrier in accordance with TSM Chapter 8 and 'Safety at Street Works and Road Works'.
- Pedestrian route to be maintained. 4m minimum width
- Constructed Kerb
- Lane Direction
- Works Boundary

3	TTM CHANGES	KK	DJH	28/01/2016
2	TTM CHANGES	KK	DJH	11/01/2016
1	INITIAL ISSUE	LG	DJH	14/07/2015
Rev	Revision details	Chkd	Appd	Date

Drawn:	BS	Preliminary
Design:	BS	For comment
Chkd:	DR	For tender
Appd:	DJH	For construction
Date:	08/10/2014	As constructed
		Other



Project Name
Cycle Superhighway East-West Construction Package 4

Drawing Title
**Transportation
TTM - TEMPORARY TRAFFIC MANAGEMENT - LAYOUT 5**

Original Drawing Size :	A1	Dimensions :	m
Scale :	1:250	Copyright ©	ConwayAecom

Drawing No	60320925-E210-CP04-TTM-0105	Rev	3
------------	-----------------------------	-----	---

Based upon a reproduction from the Ordnance Survey mapping with the permission of the Controller of Her Majesty's Stationary Office © Crown Copyright. Unauthorised reproduction infringes Crown Copyright and may lead to prosecution or civil proceedings. Transport for London, Account/Licence No. 100035971/063, 2015.

This drawing has been prepared for the use of CONWAY AECOM's client. It may not be used, modified, reproduced or relied upon by third parties, except as agreed by CONWAY AECOM or as required by law. CONWAY AECOM accepts no responsibility, and denies any liability whatsoever, to any party that uses or relies on this drawing without CONWAY AECOM's express written consent. Do not scale this document.