

LEGEND

- SP Proposed sign and post
- SP Proposed sign plate on existing post
- LC Proposed sign plate on existing lamp column
- TLRN boundary

NOTES

- All dimensions are approximate, critical dimensions are to be checked on site.
- TfL Engineering comments added to Topographical survey by David J Webb Surveys Ltd drawing no: 4171-4, dated May 2016. This drawing is to be read in conjunction with the topographical survey.

TfL RESTRICTED	Project	A20 Sidcup Bypass Road		
	Originator	Transport for London		
	Asset Classification	Traffic Signs & Road Markings		
	Location	LB of Bromley		
Scale	1:500 @ A1	Sheet no	1 of 8	
Project	A20 Sidcup Bypass Road		Subsidiary	D3 FOR CONTRACTOR DESIGN
Location	LB of Bromley		Revision	P01
Scale	1:500 @ A1		drawing No	AARC3169-TfL-120-19-DRG-TR-0001

© Crown copyright and database rights 2020 Ordnance Survey 100039971

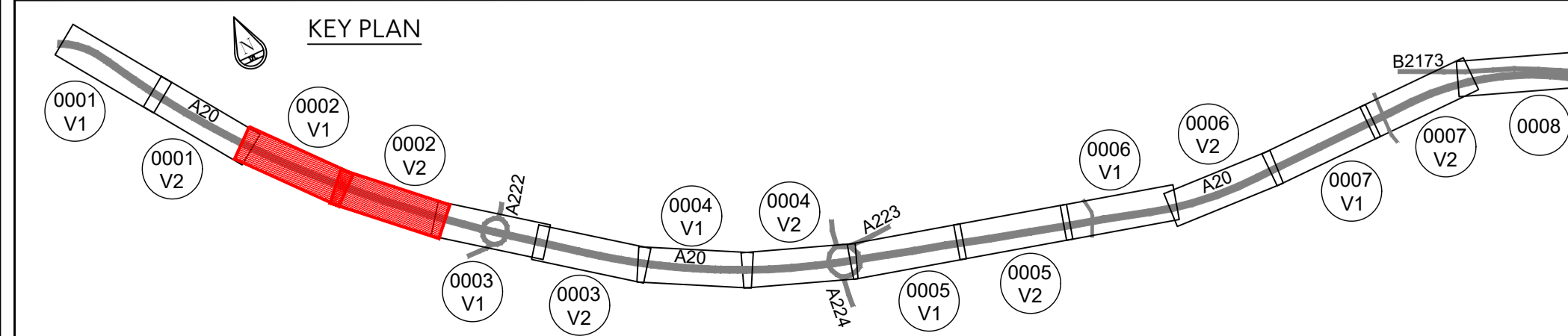
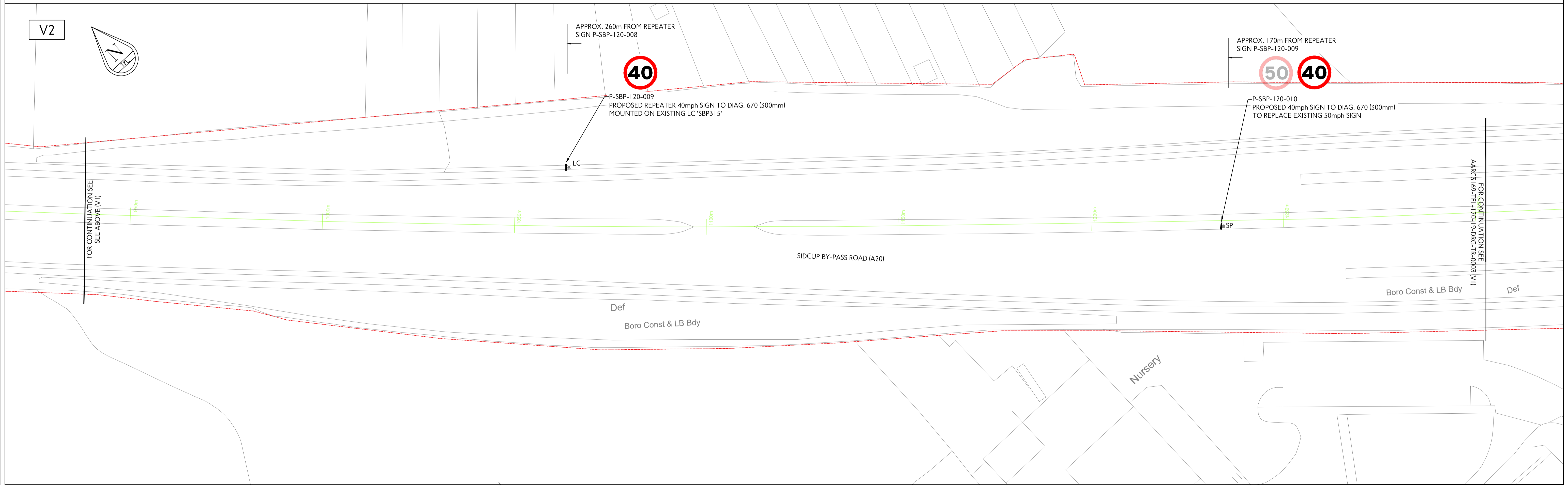

LEGEND

- SP [Symbol] Proposed sign and post
- SP [Symbol] Proposed sign plate on existing post
- LC [Symbol] Proposed sign plate on existing lamp column
- [Symbol] TLRN boundary

NOTES

- All dimensions are approximate, critical dimensions are to be checked on site.
- TfL Engineering comments added to Topographical survey by David J Webb Surveys Ltd drawing no: 4171-4, dated May 2016. This drawing is to be read in conjunction with the topographical survey.

TfL RESTRICTED	Project	A20 Sidcup Bypass Road		
	Originator	Transport for London		
	Asset Classification	Traffic Signs & Road Markings		
	Location	LB of Bromley		
Scale	1:500 @ A1	Sheet no	2 of 8	

Transport for London

submittal: D3 FOR CONTRACTOR DESIGN | revision: P01

drawing No: AARC3169-TFL-120-19-DRG-TR-0002

© Crown copyright and database rights 2020 Ordnance Survey 100039971

VI

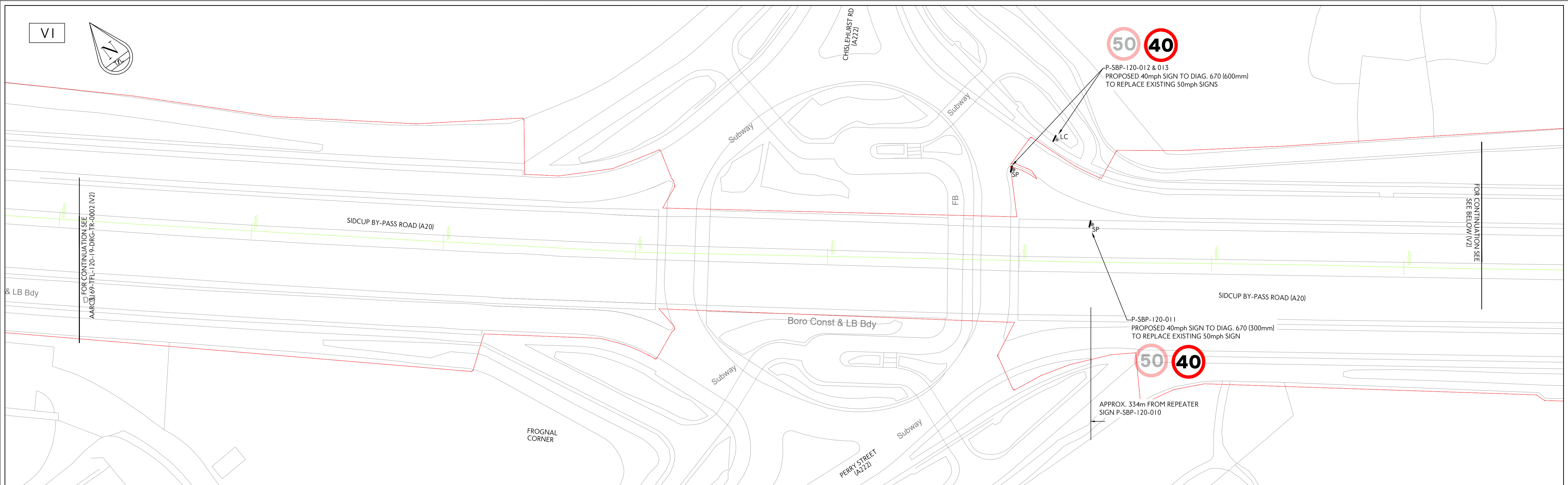
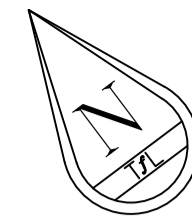

V2

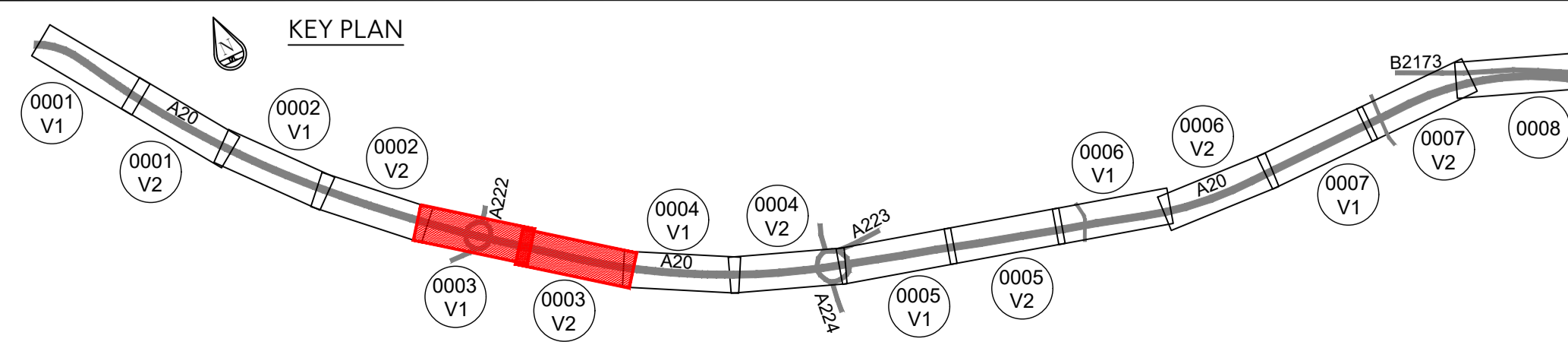
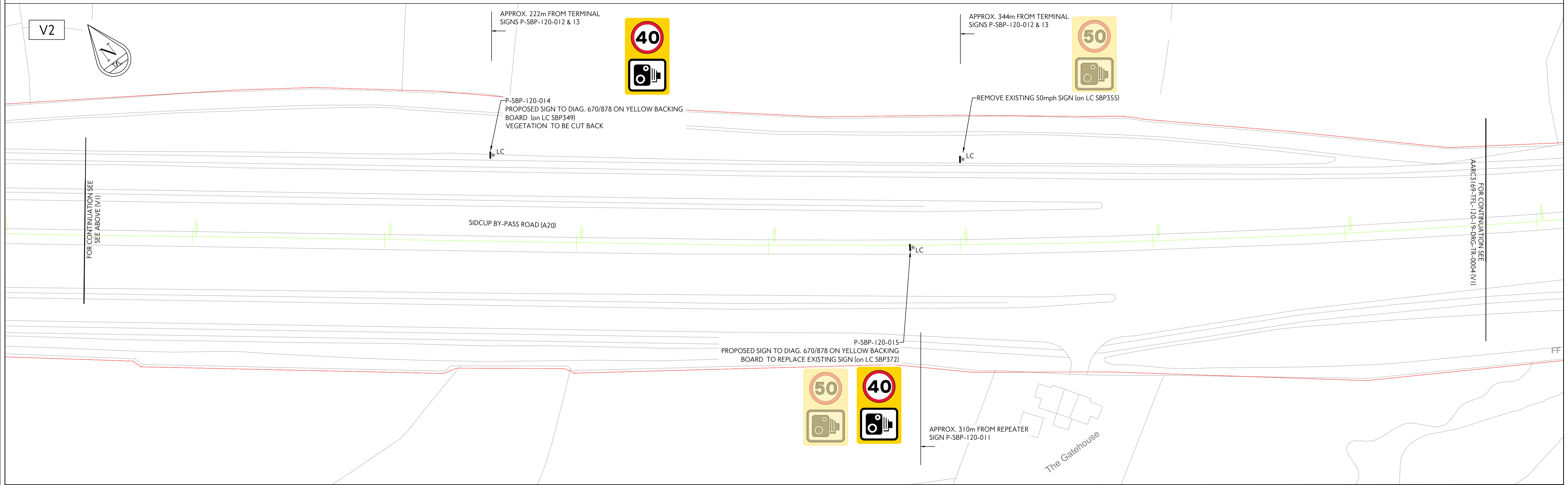

LEGEND

SP [Symbol] Proposed sign and post

SP [Symbol] Proposed sign plate on existing post

LC [Symbol] Proposed sign plate on existing lamp column

--- TLRN boundary

- NOTES**
- All dimensions are approximate, critical dimensions are to be checked on site.
 - TfL Engineering comments added to Topographical survey by David J Webb Surveys Ltd drawing no: 4171-4, dated May 2016. This drawing is to be read in conjunction with the topographical survey.

TfL RESTRICTED		Project		A20 Sidcup Bypass Road	
		Originator		Transport for London	
rev		date		details	
P01	08-09-23	First Issue	SP	HW	MA
drn	chk	app	Asset Classification		
A20 Sidcup Bypass Road			Traffic Signs & Road Markings		
Average Speed Cameras			Location		
			LB of Bromley		
Scale			Sheet no		
1:500 @ A1			3 of 8		

Transport for London

submittal: D3 FOR CONTRACTOR DESIGN | revision: P01

drawing No: AARC3169-TFL-120-19-DRG-TR-0003

© Crown copyright and database rights 2020 Ordnance Survey 100039971

VI

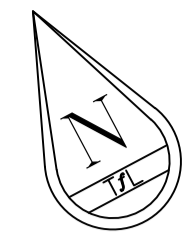

APPROX. 350m FROM REPEATER
SIGN P-SBP-120-014
APPROX. 244m FROM REPEATER
SIGN P-SBP-120-015



P-SBP-120-016
PROPOSED REPEATER 40mph SIGN TO DIAG. 670 (300mm)
MOUNTED ON EXISTING LC 'FPF011'.
VEGETATION TO BE CUT BACK

LC

Gantry

Drain

Stables

FOR CONTINUATION SEE
SEE BELOW (V2)

FOR CONTINUATION SEE
AARC3169-TFL-120-19-DRG-TR-0003 (V2)

SIDCUP BY-PASS ROAD (A20)

FF

Def

Def

Und

THE AVENUE

V2



APPROX. 321m FROM REPEATER
SIGN P-SBP-120-016



P-SBP-120-017
PROPOSED 40mph SIGN TO DIAG. 670 (300mm)
TO REPLACE EXISTING 50mph SIGN (on LC FPF045)

LC

Superstore

SIDCUP BY-PASS ROAD (A20)

Def

CRAY RD
(A224)

Subway

APPROX. 292m FROM REPEATER
SIGN P-SBP-120-017



P-SBP-120-018
PROPOSED 40mph SIGN TO DIAG. 670 (300mm)
TO REPLACE EXISTING 50mph SIGN on existing post

SM

LC

FOR CONTINUATION SEE
SEE ABOVE (V1)

FOR CONTINUATION SEE
AARC3169-TFL-120-19-DRG-TR-0005 (V1)

P-SBP-120-019
PROPOSED REPEATER 40mph SIGN TO DIAG. 670 (300mm)
MOUNTED ON EXISTING LC 'FPF053'



SM

SM

Und

Boro Const & LB Bdy

THE GREEN

SEVENONS
WAY
(A214)

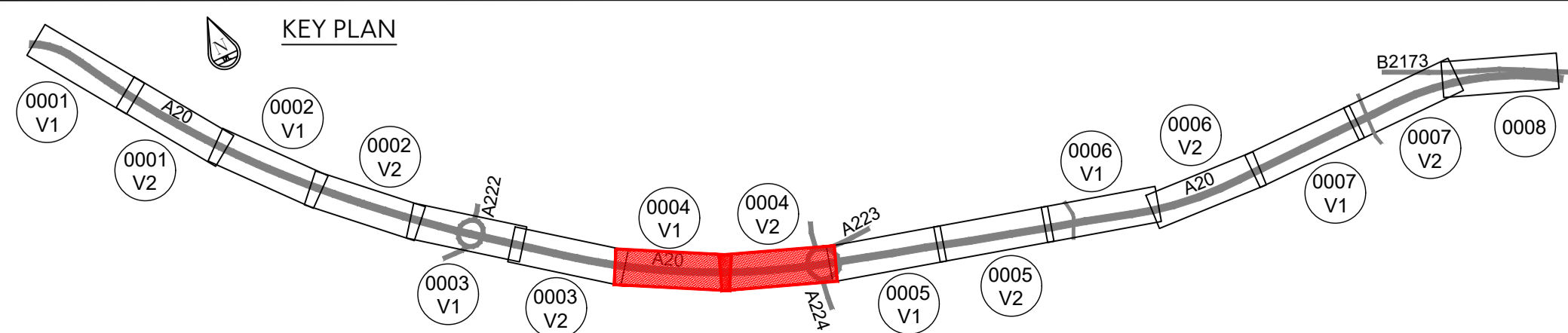

LEGEND

- SP Proposed sign and post
- SP Proposed sign plate on existing post
- LC Proposed sign plate on existing lamp column
- TLRN boundary

NOTES

1. All dimensions are approximate, critical dimensions are to be checked on site.
2. TfL Engineering comments added to Topographical survey by David J Webb Surveys Ltd drawing no: 4171-4, dated May 2016. This drawing is to be read in conjunction with the topographical survey.

TfL RESTRICTED	Project			A20 Sidcup Bypass Road		
	Originator			Transport for London		
	Asset Classification			Traffic Signs & Road Markings		
	Location			LB of Bromley		
Scale			1:500 @ A1			
Sheet no			4 of 8			
drawing No			AARC3169-TFL-120-19-DRG-TR-0004			
submittal			D3 FOR CONTRACTOR DESIGN			
revision			P01			

© Crown copyright and database rights 2020 Ordnance Survey 100039971



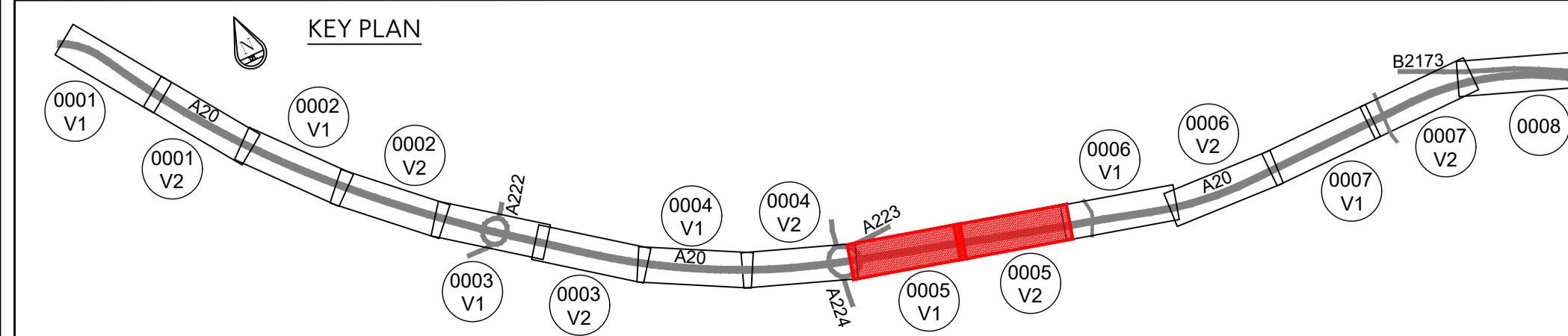
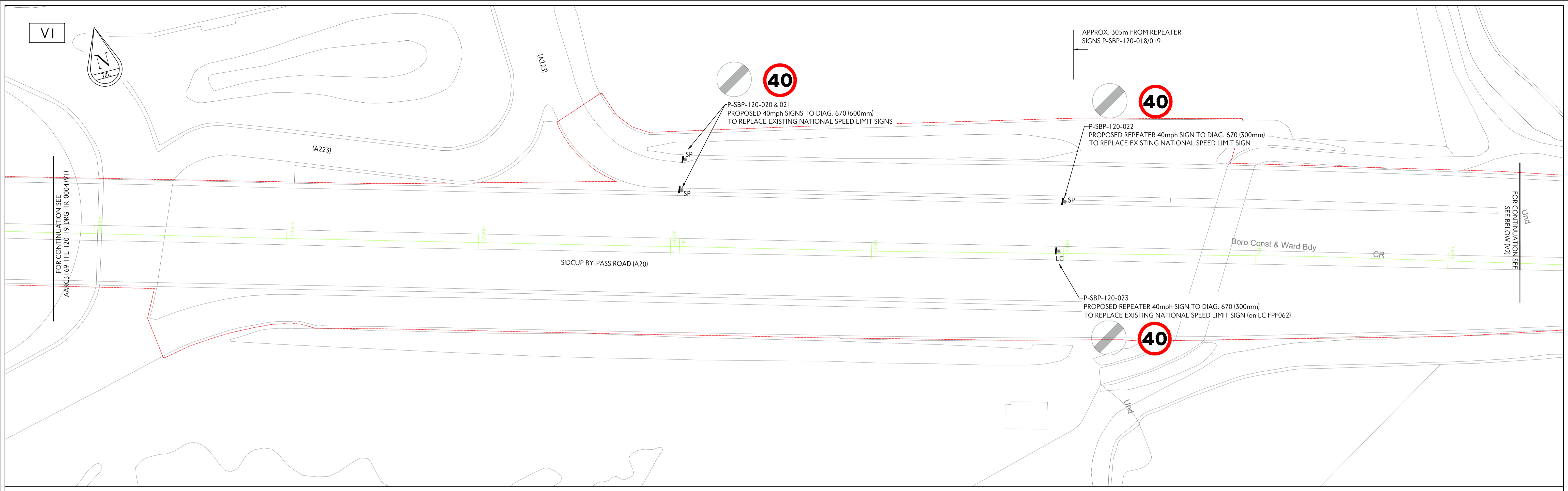

LEGEND

- SP [Symbol] Proposed sign and post
- SP [Symbol] Proposed sign plate on existing post
- LC [Symbol] Proposed sign plate on existing lamp column
- [Red line] TLRN boundary

NOTES

- All dimensions are approximate, critical dimensions are to be checked on site.
- TfL Engineering comments added to Topographical survey by David J Webb Surveys Ltd drawing no: 4171-4, dated May 2016. This drawing is to be read in conjunction with the topographical survey.

TfL RESTRICTED	Project	A20 Sidcup Bypass Road
	Originator	Transport for London
	Asset Classification	Traffic Signs & Road Markings
	Location	LB of Bromley
Scale	1:500 @ A1	Sheet no 5 of 8
Project	A20 Sidcup Bypass Road Average Speed Cameras	
Submittal	D3 FOR CONTRACTOR DESIGN	Revision P01
Drawing No	AARC3169-TFL-120-19-DRG-TR-0005	

© Crown copyright and database rights 2020 Ordnance Survey 100039971

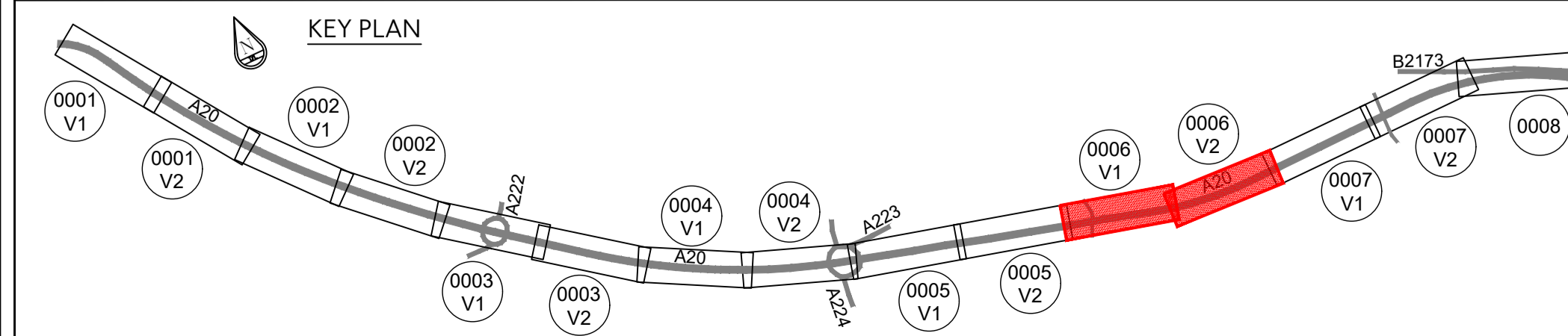
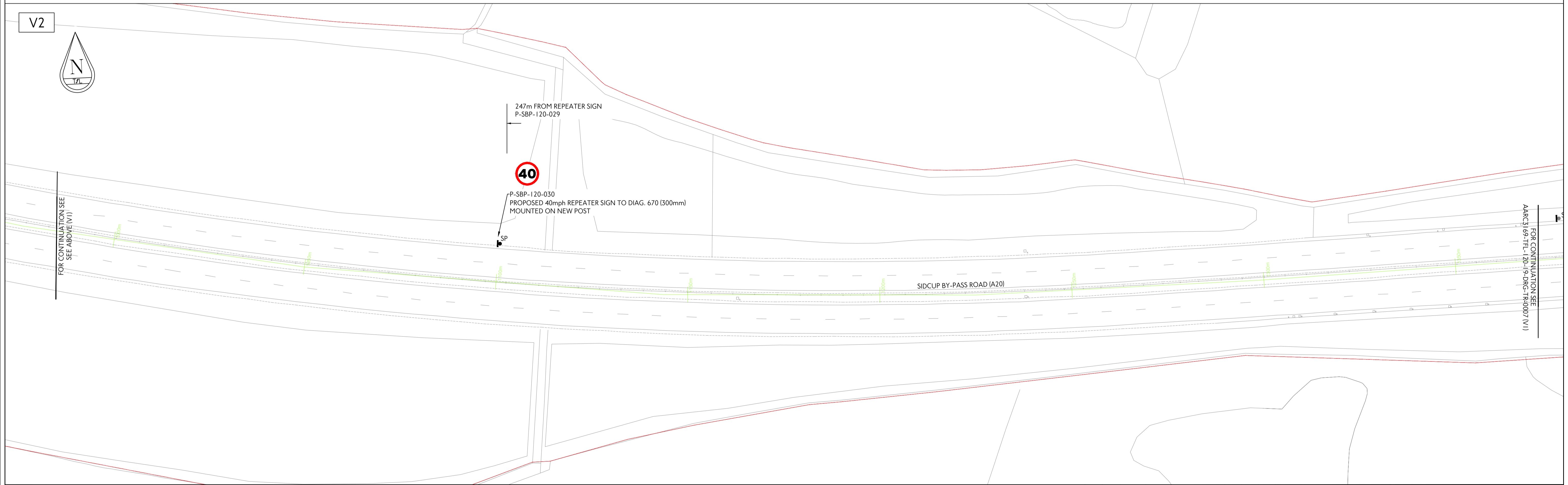
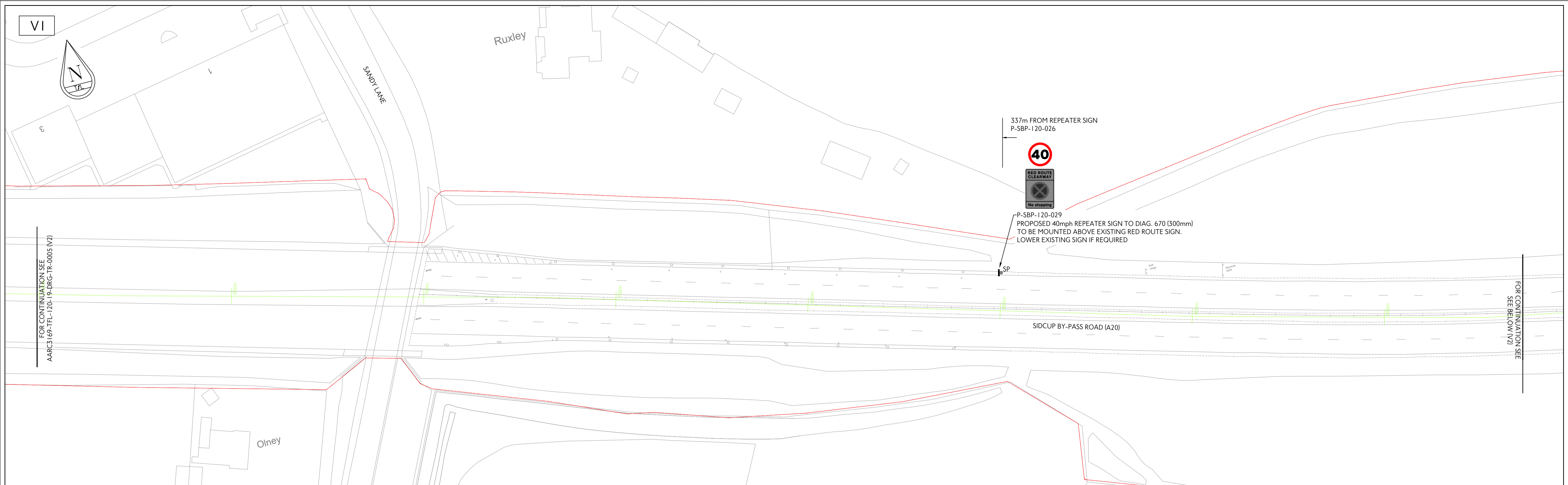

LEGEND

- SP [Symbol] Proposed sign and post
- SP [Symbol] Proposed sign plate on existing post
- LC [Symbol] Proposed sign plate on existing lamp column
- TLRN boundary

NOTES

- All dimensions are approximate, critical dimensions are to be checked on site.
- TfL Engineering comments added to Topographical survey by David J Webb Surveys Ltd drawing no: 4171-4, dated May 2016. This drawing is to be read in conjunction with the topographical survey.

TfL RESTRICTED	Project	A20 Sidcup Bypass Road		
	Originator	Transport for London		
	Asset Classification	Traffic Signs & Road Markings		
	Location	LB of Bromley		
Scale	1:500 @ A1	Sheet no	6 of 8	

suitability: D3 FOR CONTRACTOR DESIGN | revision: P01
 drawing No: AARC3169-TFL-120-19-DRG-TR-0006
© Crown copyright and database rights 2020 Ordnance Survey 100039971

VI

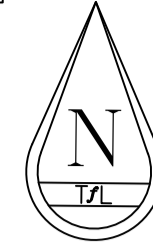

274m FROM REPEATER SIGN
P-SBP-120-030

40

P-SBP-120-031
PROPOSED 40mph REPEATER SIGN TO DIAG. 670 (300mm)
MOUNTED ON NEW POST

40

340m FROM REPEATER SIGN
P-SBP-120-031

P-SBP-120-032
PROPOSED 40mph REPEATER SIGN TO DIAG. 670 (300mm)
MOUNTED ON NEW POST
VEGETATION TO BE CUT BACK

FOR CONTINUATION SEE
AARC3169-TFL-120-19-DRG-TR-0006 (V2)

FOR CONTINUATION SEE
SEE BELOW (V2)

SIDCUP BY-PASS ROAD (A20)

V2

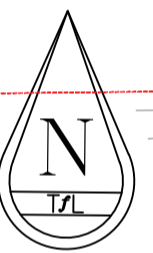

(Travellers Site)

Filling Station

COOKHAM ROAD

1 to 12
The Camp Site

Boro Const & LB Bd. Def

319m FROM REPEATER SIGN
P-SBP-120-032

40

P-SBP-120-033
PROPOSED 40mph REPEATER SIGN TO DIAG. 670 (300mm) MOUNTED
ON EXISTING CAMERA POST
YUNEX TO INSTALL AVERAGE SPEED CAMERA ON EXISTING POST

Restaurant
Swanley Connect Services

SIDCUP BY-PASS ROAD (A20)

FOR CONTINUATION SEE
SEE ABOVE (V1)

FOR CONTINUATION SEE
AARC3169-TFL-120-19-DRG-TR-0008

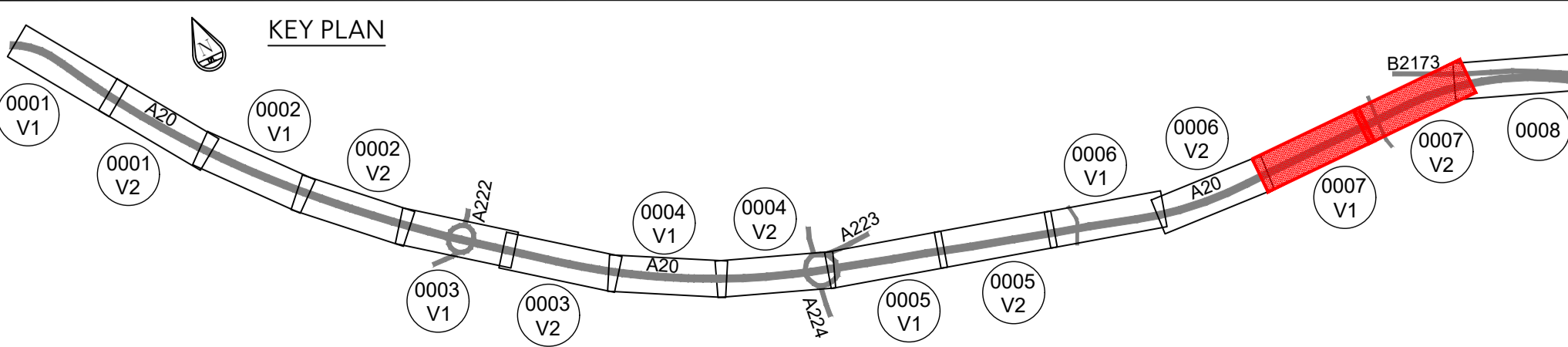

LEGEND

- SP [Symbol] Proposed sign and post
- SP [Symbol] Proposed sign plate on existing post
- LC [Symbol] Proposed sign plate on existing lamp column
- [Red Line] TLRN boundary

- NOTES**
- All dimensions are approximate, critical dimensions are to be checked on site.
 - TfL Engineering comments added to Topographical survey by David J Webb Surveys Ltd drawing no: 4171-4, dated May 2016. This drawing is to be read in conjunction with the topographical survey.

TfL RESTRICTED	Project		A20 Sidcup Bypass Road		
	Originator		Transport for London		
	Asset Classification		Traffic Signs & Road Markings		
	Location		LB of Bromley		
Scale		Sheet no		drawing No	
1:500 @ A1		7 of 8		AARC3169-TFL-120-19-DRG-TR-0007	



subtitled FOR CONTRACTOR DESIGN revision P01

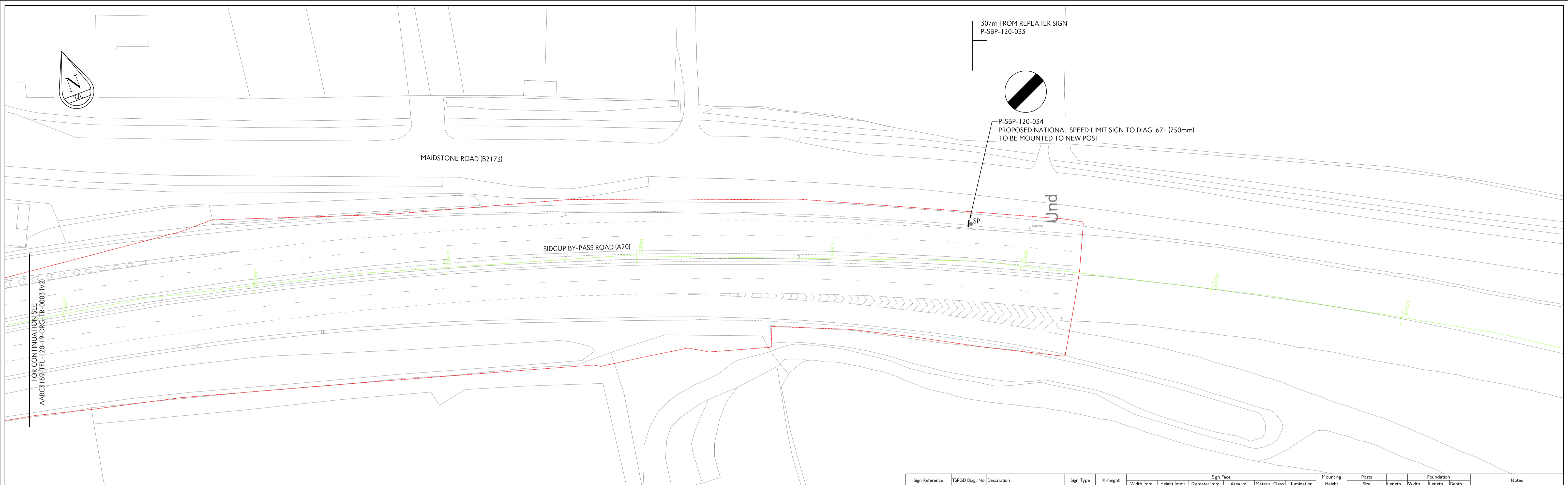

Sign Reference	TSRGD Diag. No.	Description	Sign Type	X-height	Width (mm)	Height (mm)	Sign Face		Material Class	Illumination	Mounting	Posts			Foundation			Notes
							Diameter (mm)	Area (m²)				Height	Size	Length	Width	Length	Depth	
P-SBP-120-001	670	40mph - Maximum speed limit	Regulatory	-	-	-	300	0.07	Class RA2	No	as existing						To be mounted on existing LC 'SR271', remove existing 50mph limit sign and light unit	
P-SBP-120-002	670	40mph - Maximum speed limit	Regulatory	-	-	-	300	0.07	Class RA2	No	as existing						To be mounted on existing LIT post, remove existing 50mph limit sign and light unit	
P-SBP-120-003	670	40mph - Maximum speed limit	Regulatory	-	-	-	300	0.07	Class RA2	No	as existing						To be mounted on existing post back to back with existing 50mph limit sign, remove existing 50mph limit sign	
P-SBP-120-004	670	40mph - Maximum speed limit	Regulatory	-	-	-	300	0.07	Class RA2	No	as existing						To be mounted on existing LC 'SBP283'	
P-SBP-120-005	670	40mph - Maximum speed limit	Regulatory	-	-	-	300	0.07	Class RA2	No	as existing						To be mounted on existing post, remove existing 50mph limit sign	
P-SBP-120-006	670/878	40mph - Maximum speed limit / area in which enforcement cameras are in use	Regulatory	-	410	710	-	0.29	Class RA2	No	as existing						To be mounted on existing post, remove existing 50mph limit / camera sign	
P-SBP-120-007	670	40mph - Maximum speed limit	Regulatory	-	-	-	300	0.07	Class RA2	No	as existing						To be mounted on existing post, remove existing 50mph limit sign	
P-SBP-120-008	670	40mph - Maximum speed limit	Regulatory	-	-	-	300	0.07	Class RA2	No	1000						To be mounted on existing LC 'SBP307' vegetation to be cut back	
P-SBP-120-009	670	40mph - Maximum speed limit	Regulatory	-	-	-	300	0.07	Class RA2	No	1000						To be mounted on existing LC 'SBP315'	
P-SBP-120-010	670	40mph - Maximum speed limit	Regulatory	-	-	-	300	0.07	Class RA2	No	as existing						To be mounted on existing post back to back with existing 50mph limit / camera sign	
P-SBP-120-011	670	40mph - Maximum speed limit	Regulatory	-	-	-	300	0.07	Class RA2	No	as existing						To be mounted on existing post	
P-SBP-120-012	670	40mph - Maximum speed limit	Regulatory	-	-	-	600	0.28	Class RA2	Yes	as existing						To be mounted on existing LC 'SBP337', remove existing 50mph limit sign	
P-SBP-120-013	670	40mph - Maximum speed limit	Regulatory	-	-	-	600	0.28	Class RA2	Yes	as existing						To be mounted on existing LIT post, remove existing 50mph limit sign	
P-SBP-120-014	670/878	40mph - Maximum speed limit / area in which enforcement cameras are in use	Regulatory	-	410	710	-	0.29	Class RA2	No	1000						To be mounted on existing LC 'SBP349' vegetation to be cut back, remove existing 50mph limit / camera sign from LC 'SBP355'	
P-SBP-120-015	670/878	40mph - Maximum speed limit / area in which enforcement cameras are in use	Regulatory	-	410	710	-	0.29	Class RA2	No	as existing						To be mounted on existing LC 'SBP372', remove existing 50mph limit / camera sign	
P-SBP-120-016	670	40mph - Maximum speed limit	Regulatory	-	-	-	300	0.07	Class RA2	No	1000						To be mounted on existing LC 'FFFO11' vegetation to be cut back	
P-SBP-120-017	670	40mph - Maximum speed limit	Regulatory	-	-	-	300	0.07	Class RA2	No	as existing						To be mounted on existing LC 'FFFO45', remove existing 50mph limit sign	
P-SBP-120-018	670	40mph - Maximum speed limit	Regulatory	-	-	-	300	0.07	Class RA2	No	as existing						To be mounted on existing post	
P-SBP-120-019	670	40mph - Maximum speed limit	Regulatory	-	-	-	300	0.07	Class RA2	No	as existing						To be mounted on existing LC 'FFFO53', remove existing 50mph limit sign	
P-SBP-120-020	670	40mph - Maximum speed limit	Regulatory	-	-	-	600	0.28	Class RA2	Yes	as existing						To be mounted on existing LIT post, remove existing National Speed Limit sign	
P-SBP-120-021	670	40mph - Maximum speed limit	Regulatory	-	-	-	600	0.28	Class RA2	Yes	as existing						To be mounted on existing LIT post, remove existing National Speed Limit sign	
P-SBP-120-022	670	40mph - Maximum speed limit	Regulatory	-	-	-	300	0.07	Class RA2	Yes	as existing						To be mounted on existing LIT post, remove existing National Speed Limit sign	
P-SBP-120-023	670	40mph - Maximum speed limit	Regulatory	-	-	-	300	0.07	Class RA2	Yes	as existing						To be mounted on existing LIT LC 'FFFO62', remove existing National Speed Limit sign and light unit	
P-SBP-120-024	670	40mph - Maximum speed limit (repeater)	Regulatory	-	-	-	300	0.07	Class RA2	No	1000						To be mounted on existing LC 'FFGO25'	
P-SBP-120-025	670	40mph - Maximum speed limit (repeater)	Regulatory	-	-	-	300	0.07	Class RA2	No	as existing						To be mounted above existing red route sign, lower existing sign if required	
P-SBP-120-026	670	40mph - Maximum speed limit (repeater)	Regulatory	-	-	-	300	0.07	Class RA2	No	1000						To be mounted on existing LC 'FFGO09' vegetation to be cut back	
P-SBP-120-027	878	Area in which enforcement cameras are in use	Regulatory	75	735	955	-	0.70	Class RA2	No	1000	76.1 x 3.2 CHS	2805	300 dia	-	800		
P-SBP-120-028	959.1	Area in which enforcement cameras are in use	Regulatory	75	735	955	-	0.70	Class RA2	No	as existing						To be mounted on existing posts back to back with existing 'Low Emission Zone' sign	
P-SBP-120-029	670	40mph - Maximum speed limit (repeater)	Regulatory	-	-	-	300	0.07	Class RA2	No	as existing						To be mounted above existing red route sign, lower existing sign if required	
P-SBP-120-030	670	40mph - Maximum speed limit (repeater)	Regulatory	-	-	-	300	0.07	Class RA2	No	1000	76.1 x 3.2 CHS	1950	300 dia	-	600		
P-SBP-120-031	670	40mph - Maximum speed limit (repeater)	Regulatory	-	-	-	300	0.07	Class RA2	No	1000	76.1 x 3.2 CHS	1950	300 dia	-	600		
P-SBP-120-032	670	40mph - Maximum speed limit (repeater)	Regulatory	-	-	-	300	0.07	Class RA2	No	1000	76.1 x 3.2 CHS	1950	300 dia	-	600	Vegetation to be cut back	
P-SBP-120-033	670	40mph - Maximum speed limit (repeater)	Regulatory	-	-	-	300	0.07	Class RA2	No	1000	76.1 x 3.2 CHS	1950	300 dia	-	600		
P-SBP-120-034	671	National Speed Limit	Regulatory	-	-	-	750	0.44	Class RA2	No	1000	76.1 x 3.2 CHS	2450	300 dia	-	650		

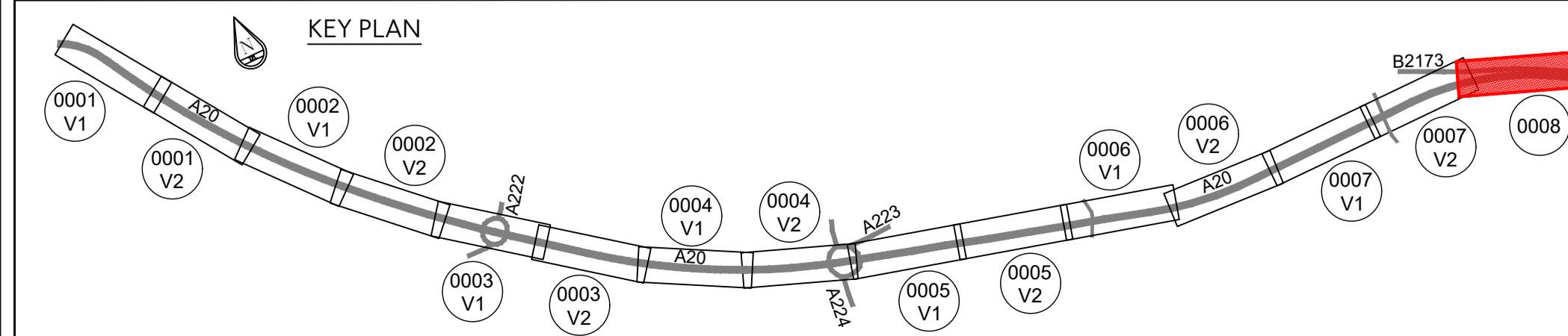

- LEGEND**
- SP Proposed sign and post
 - SP Proposed sign plate on existing post
 - LC Proposed sign plate on existing lamp column
 - TLRN boundary

- NOTES**
1. All dimensions are approximate, critical dimensions are to be checked on site.
 2. TFL Engineering comments added to Topographical survey by David J Webb Surveys (td drawing no: 4171-4, dated May 2016. This drawing is to be read in conjunction with the topographical survey).

TFL RESTRICTED

Project		A20 Sidcup Bypass Road	
Originator		Transport for London	
Asset Classification		Traffic Signs & Road Markings	
Location		LB of Bromley	
Scale		1:500 @ A1	
Sheet no		8 of 8	

subtitled

D3 FOR CONTRACTOR DESIGN

drawing No

AARC3169-TFL-120-19-DRG-TR-0008

revision

P01

revision

AARC3169-TFL-120-19-DRG-TR-0008

© Crown copyright and database rights 2020 Ordnance Survey 100039871